

## 1. Introduction

Bluetooth is a new short-distance wireless communication technology. Any devices with Bluetooth feature, such as mobile phones, PDA, PC, headsets, mouse, keypads, keyboards, printers and other mobile fittings, can work as wireless devices. Designed with global standards, Bluetooth technology applies to internationally certified ISM bandwidth. The frequency band ranging from 2.4 GHz to 2.48 GHz is divided up into 79 channels by way of frequency hopping up to 1600 times for data transmission with a distance of 10 meters.

## 2. Packing List

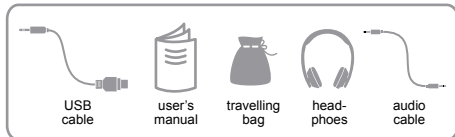

- The accessories are subject to change for improving product performance without prior notice. The real products prevail.

## 3. Product specification

Bluetooth specification: Support V2.1+EDR with Handsfree Profile 1.5., Headset Profile 1.1 and A2DP profile 1.2. (Class II)  
Standby time: 100 hours  
Talking time: 10 hours  
Music playing time: 8 hours  
Effective distance: up to 10 meters  
Weight: 115 g  
Certification: CE; FCC; ROHS; BQB

## 4. About FH0906B

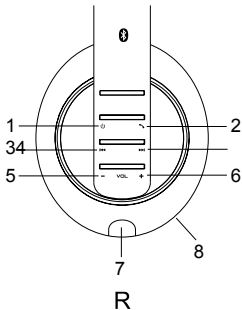

1. Power On /Off /Pair
2. Play / Stop / Call /End (Multifunction Key)
3. Previous
4. Next
5. VOL-
6. VOL+
7. Wired headphone jack /Charge jack
8. Mic

## 5. Headphone Charging

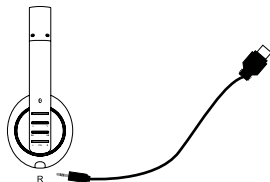

1. Built-in rechargeable Lithium battery.
2. It must take 4 hours for the first time charging.
3. Connect the charger cable to the charger connector. The Red indicator light is displayed during charging. Charging the battery fully may take about 2 hours.
4. When the battery is fully charged, the Red indicator light will be off. The fully charged battery has power for up to 8 hours of talking time, up to 6-8 hours of music playing time, up to 100 hours of standby time.

## 6. Wearing



## 7. Switch on or off

1. Press and hold the multifunction key for about 3 seconds, the Blue indicator light is displayed. This shows the earphone is power on.
2. Press and hold the multifunction key until the Red indicator light is displayed. This shows the earphone is power off.

## 8. Pair the headphone

If your phone supports the A2DP Bluetooth profile and has a music player feature, you can use the phone to make and receive calls, and to play music with the headset.

1. Ensure that your phone or music device is on and the headset is off.
2. Press and hold the multifunction key for about 5 seconds until the Red indicator light and the Blue indicator light starts to flash quickly.
3. Activate the Bluetooth feature on your phone or music player, and set it to search for Bluetooth devices.
4. Select the headset FH0906B from the list of founded devices on your phone or music player.
5. Enter the passcode 0000 to pair and connect the headset to your device. If your device does not have a keypad, it may use this passcode by default.
6. When the headset is connected to your device and is ready for use, the Blue indicator light will flash every 2 seconds.

## 9. Operating

### Receiving a call

Short press the Multifunction key to receive an incoming call.

### Ending a call

Short press the Multifunction key to end a call

### Making a call

When you make a call via the mobile phone, the call will be transferred to your headset automatically, depending on the phone setup. If your phone does not support this function, short press the Multifunction key to receive an incoming call.

### Voice call activation\*

If your phone supports this feature with the headset, when no call is in progress, press and hold the multifunction key for about 2 seconds. Proceed as described in the phone user guide.

### Redialing the last number\*

To redial the number you last called (if your phone supports this feature with the headset), when no call is in progress, press the multifunction key twice.

### Rejecting a call\*

Press the multifunction key twice to reject a call.

### Volume control

Press either volume key during a call or when you listen to music to adjust the volume.

### Note:

The functions with \* mark should be supported by your mobile phone. For more information, refer to the User Manual of your mobile phone.

## 10. Music listening

To listen to music, pair and connect the headset to a device that supports the A2DP Bluetooth profile. (See "Pair the headset"). To play music, use the playback controls on the connected device. If you answer or make a call while listening to the music, the music will pause until you end the call.

Function	Description
Play or Pause	Press The Multifunction Key
Music Volume	Press The "+" key   Volume Increase Press The "-" key   Volume Decrease
Previous	Press The "⏮" key
Next	Press The "⏭" key

## 11. Wired Headphone

When connecting with audio cable, FH0906B can be used as a normal headphone, it can be connected with earphone audio output facilities such as MP3, MP4.

The built-in microphone doesn't work at this time

## 12. Troubleshooting

### Continuous cracking noise

- To obtain perfect sound quality, please don't take earphone away too much from mobilephone.

### Unable to hear any sound

- Press the Volume + button on the headset to increase the volume.
- Ensure your headset is properly paired with the mobile phone.
- Ensure the headset is connected to the mobile phone. If the headset is not connected to the phone via the Bluetooth option, please follow the pairing process to connect them. For details, refer to the part "Pairing the Headset" in this manual.

### Unable to connect

The pairing settings between your headset and mobile phone may be deleted. Follow the part "Pairing the Headset" in this manual to pair them again.

### Can this device apply to other Bluetooth devices?

- FH0906B Bluetooth headset is designed to pair Bluetooth mobile phones. In addition, it is compatible with Bluetooth Version 1.1, Version 1.2 or 2.0 and supports operations upon other Bluetooth devices.
- Some functions, such as "Rejecting a call", "Redialing", or "Voice dialing", are only available while supported by your mobile phone. Please check the phone manual for further information.

## 13. Maintain your headphone

- Store the device after it is power off. Keep it away from extreme temperature (45°C/113°F above, including direct sunlight or -10°C/14°F below) for storage. Otherwise it may shorten the service life of the battery and harm the operation.
- High temperature may also damage the product performance. If the device contacts water or other liquids, wipe away the water stains on the device.

## 14. Protect your hearing

### Warning

The headset is able to provide extreme high volume and sharp tone. Exposure to such a sound may cause permanent hearing impairment. The volume level may differ due to your phone settings, the answering and volume settings, and the environmental factors. Before using this device, please read the safety guide below.

### Safety guide

Perform the following steps before use:

- Minimize the volume before wearing the headset. Then, adjust the volume to a proper level slowly after you wear it.
- During operation, keep the volume as low as possible. Avoid using the device in noisy surroundings, as you may have to increase the volume. If you have to increase the volume, control the speed for volume adjusting.

### Others

- If you feel uncomfortable or a drumming in your ears, stop using the headset and seek medical assistance immediately.
- Continuous exposure to high volume may have you adapted to the volume level. This may result in permanent hearing loss without causing discomfort.

### Note:

- It is dangerous and illegal (in some jurisdictions) to use the headset when you are driving a car, a motorcycle, ship, or a bike. Acquaint yourself with the local laws and regulations. If you have to use the headset while working on activities that require attention to be focused on, be careful. In this case, take off the headset or turn it off to avoid distraction, and thus the occurrence of accidents or hurts.
- Keeping the device out of the reach of small children:  
The packing products and the plastic bags for the accessories are not toys. The bag itself and those small fittings inside may cause suffocation. Do not attempt to disassemble the device. No parts embedded can be replaced or repaired by users.  
Only authorized dealers or maintenance centers can disassemble this product. For changes of any parts due to any reasons, including normal wear, break, or damages, contact your dealer.
- Keep the product away from raindrops or other liquids.

Do not use your headset at areas with flammable gases. This may cause a fire.