

UNIVERSAL VR GLASSES 3D + REMOTE CONTROL

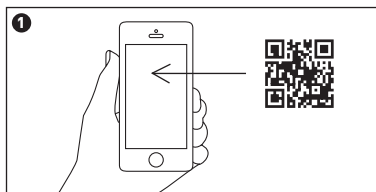

Thank you for purchasing glasses for 3D visualization. Before using refer to the instruction manual.

1. INSTAL APPLICATION SOFTWARE
2. INSTAL THE DVICES
3. TEST BEFORE USE
4. OTHER NOTES



1. INSTAL APPLICATION SOFTWARE
Use your smartphone to scan Quick Response Code.

2. INSTAL THE DVICES
 - a. Place your smartphone.
 - b. Align the centre line of smartphone sceern to product's midpoint mark.



3. TEST BEFORE USE
 - a. To have the best performance, adjust Pupillary Distance to make your eye pupils align to the glass centers.
 - b. Adjust focal distance.
 - c. Frontal pancel is removable. After removing smartphone camera is exposed. Then other software can be used.

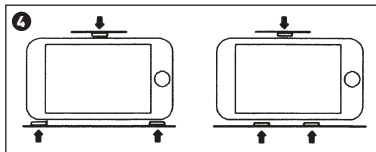

4. OTHER NOTES
 - a. Mobile phone size should not exceed 183x83mm
 - b. 3x of rubber pads. Steak the rubber pads on the smartphone holder according to the position of the device buttons. Please refer to drawings.

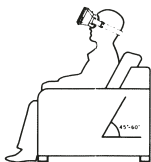

Focal lenght: 70-75mm / Ø42 / FOV-70°
Adjustable range: 65-75mm
Interpupillary distance: 58-72mm

UWAGA! WARNING! THE SMARTPHONE CAN BE CONNECTED TO THE POWER SUPPLY DURING USING 3D GLASSES. USING 3D GLASSES MAY CAUSE DIZZINESS, NAUSEA AND OTHER SYMPTOMS. IN THIS CASE, REMOVE THE GLASSES. PREGNANT WOMEN, PEOPLE WITH HIGH BLOOD PRESSURE, FEAR OF HEIGHTS SHOULD NOT USE THE GLASSES. BEFORE USING, SIT COMFORTABLY. REMEMBER! NOT TO WALK AFTER ASSUMPTION THE GLASSES.