

INSTRUKCJA INSTALACJI

Uchwyt TV

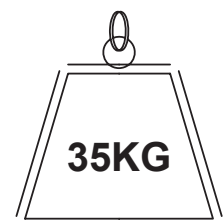

Przewidywany czas
montażu przy użyciu
odpowiednich narzędzi
- 30 minut

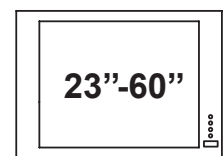
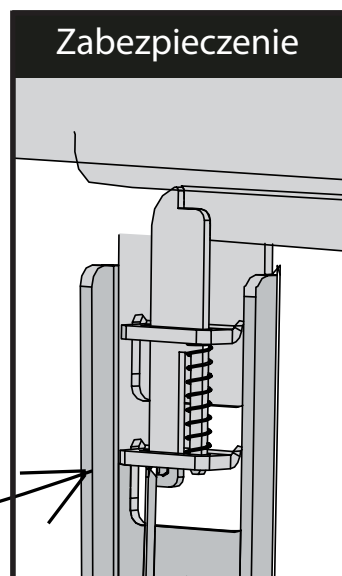
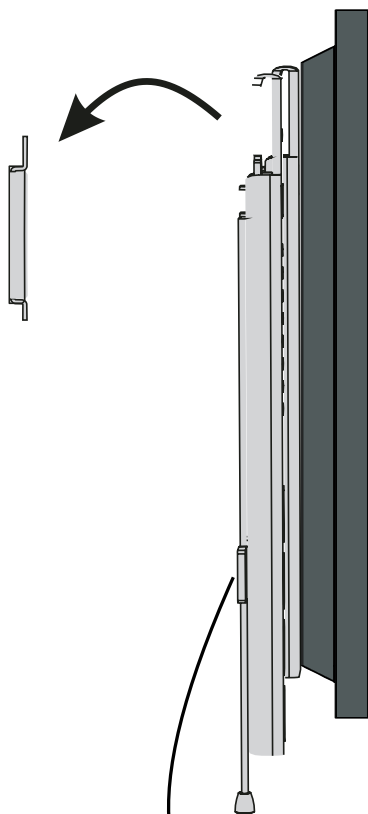
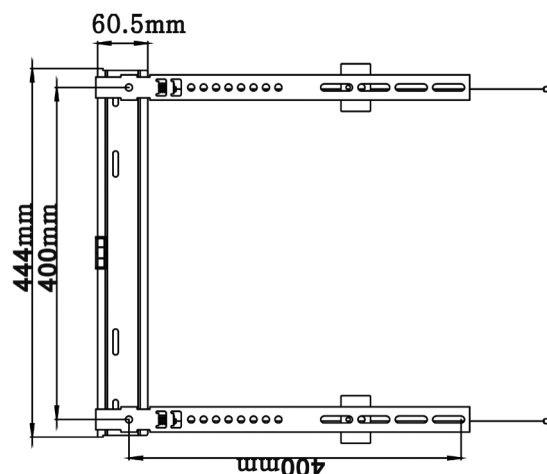

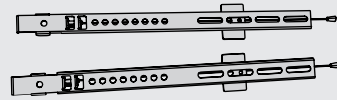
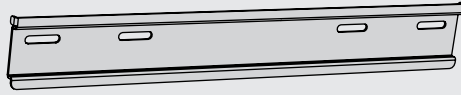

A
M4x12mm
(x4 szt.)



B
M5x12mm
(x4 szt.)



C
M6x12mm
(x4 szt.)



D
M8x15mm
(x4 szt.)



E
kołek M6
(x4 szt.)



F
M6
(x4 szt.)



G1
Podkładka
(x6 szt.)

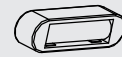

G2
LEVEL
(x1 szt.)



H
stabilizator wspornika
(x2 szt.)

1a

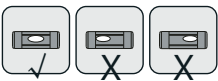
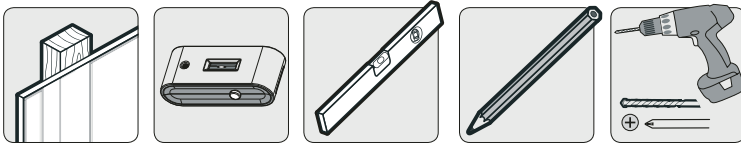

Powierzchnia drewniana

G2

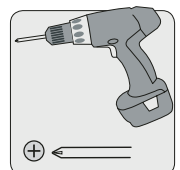
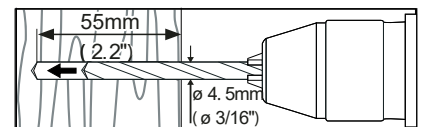
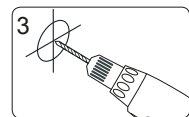
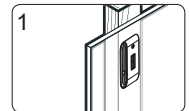

1b

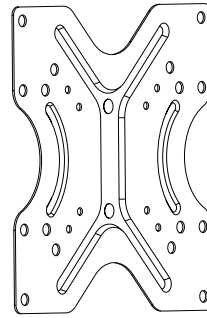
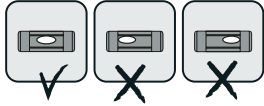
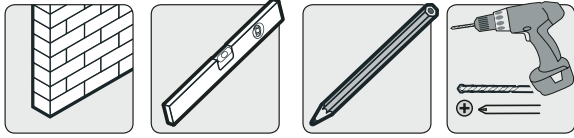

Betonowa ściana

G2

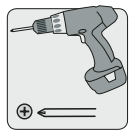
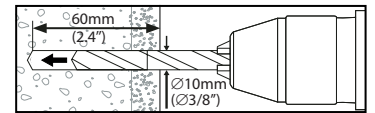
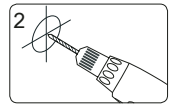
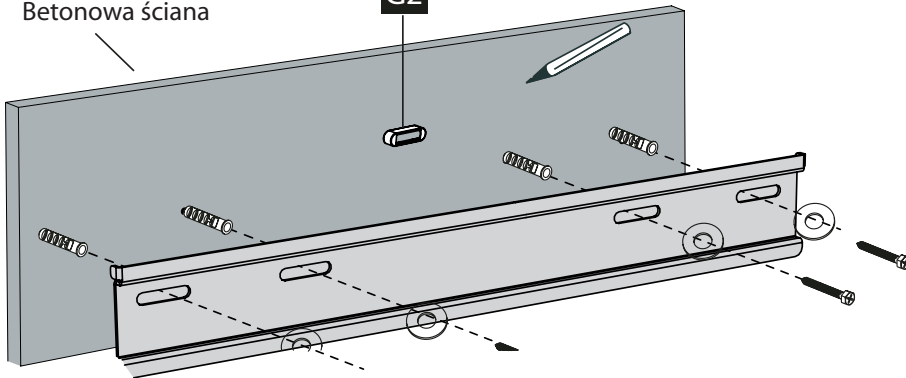

2

