

SOUNDBAR SPEAKER SYSTEM



DEAR CUSTOMER:

Thank you for buying this product !
Prior to first use, please read the manual carefully.

Specifications

Output power: 120W (RMS)
Driver Unist: 5.25"x2+2.5"x4+1"x2
Frequency response: 20Hz-20KHz
Separation: ≥ 40 dB
S / N: ≥ 55 dB
Distortion: $\leq 1\%$ (1K, 1W)
Power supply: $\sim 230V/50Hz$
Dimensions :L918 x H95 x D185 (mm)

Features:

- Quality Soundbar with built-in amplifier
Full audio spectrum performances, ideal for your favourite entertainment from Mp3, Mp4, CD/DVD movies and digital playbacks.
Quality materials : Only the best components to recreate sound faithfully across all frequencies.

Package contents

Soundbar	1 pc
Remote control	1 pc
User manual	1 pc
Audio input cord	1 pc

NO.1

Front panel

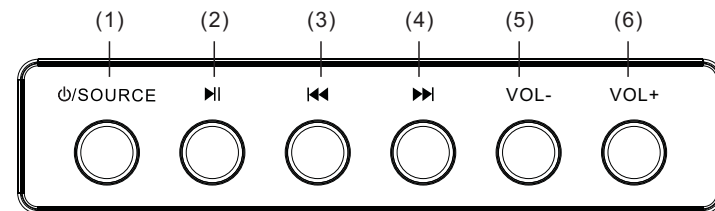

- 1.The Speaker system is in "⏻" (stand by) mode when power on, with the orange LED Flashing. Please press the "⏻/SOURCE" to select appropriate source. Keeping the "⏻/SOURCE" key pressed for long will put it back in "⏻" (stand by) mode.
* You can toggle through the input modes by pressing the "⏻/SOURCE" key." BT" Denotes Bluetooth Mode. "AU"Denotes AUX Mode."USB" Denotes USB mode.
- 2.Play/Pause the songs.
3. ⏮ :Play the previous song.
4. ⏭ :Play next song.
5. VOL-: To decrease the Volume.
6. VOL+: To increase the Volume.

Rear panel

- 1.ARC Input
- 2.USB Slot
- 3.Optical Input
- 4.INPUT L/R Input
- 5.AC Power cord

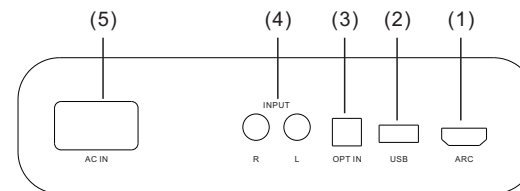

NO.2

How to use the remote control

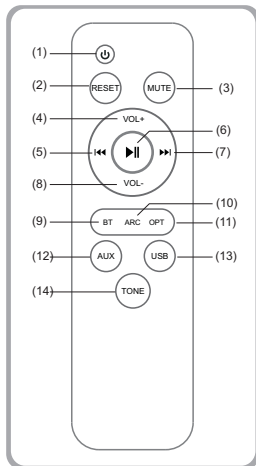

1. ⏻
2. RESET
3. MUTE
4. VOL+
5. ⏮
6. ⏪
7. ⏭
8. VOL-
9. BT
10. ARC
11. OPT
12. AUX
13. USB
14. TONE

1. ⏻ : Power ON or Standby modes.
2. RESET: To reset the system. All settings change to default level after pressing.
3. MUTE: Turn volume off. Depress again to activate the sound.
4. VOL+: To increase the Volume by short or long press of VOL+.
5. ⏮ : Play the previous song by pressing "⏮" but not in AUX mode.
6. ⏪ : Play/pause in USB/BT mode and MUTE in AUX mode.
7. ⏭: Play next song by pressing "⏭", but not in AUX mode.
8. VOL-: To decrease the Volume by short or long press of VOL-
9. BT: Bluetooth mode selection.

Press "BT" button on the remote to convert to Bluetooth input mode, LED display right bottom start to flash fast to search the Bluetooth device. Turn on your mobile Bluetooth device and search the devicename " BT SPEAKER ", paired them well. When you have successfully paired your mobile to the speaker system, the LED right bottom flashes slowly . When starting to play your mobile music, the LED dot on the right bottom is on . The functions as

"PREVIOUS/NEXT", "PLAY/PAUSE", can operate via the front panel. On BT mode, when connecting with mobile, press "⏭" for 3 seconds, bluetooth function can be force-disconnected .

10. ARC: HDMI ARC mode selection.
11. OPT: Optical mode selection.
12. AUX: AUX input mode selection.
13. USB: USB mode selection.
14. TONE : Press to adjust Bass&Treble settings by using VOL+/- buttons. Bass&Treble levels:-6(min)~+6(max)

Positioning the speakers

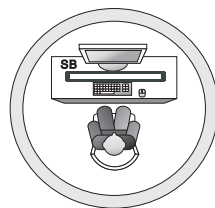
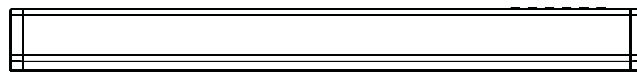

Ideal listening position and placement

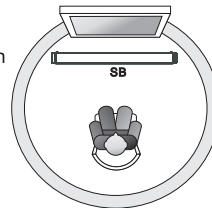

SB-soundbar

① Soundbar Speaker

Place it near the TV or DVD player.

In use please pay attention to the following items:

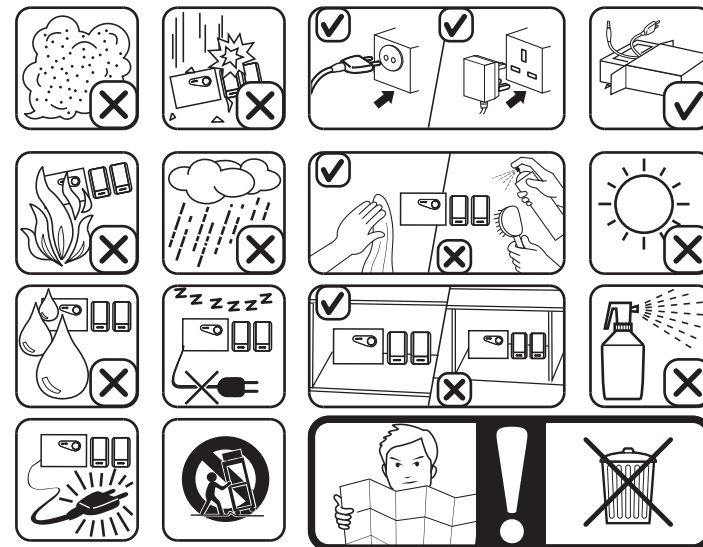

*if the remote is not working. Please replace the batteries and try again. Thank you